

Kalzip Dachwege Safety Plus
Kalzip Walkways Safety Plus

03-2021

Kalzip GmbH
August-Horch-Straße 20-22
56070 Koblenz - Germany
T +49 (0) 261 - 9834-0
F +49 (0) 261 - 9834-100
www.kalzip.com

System Safety Plus mit Geländer
System Safety Plus with handrail

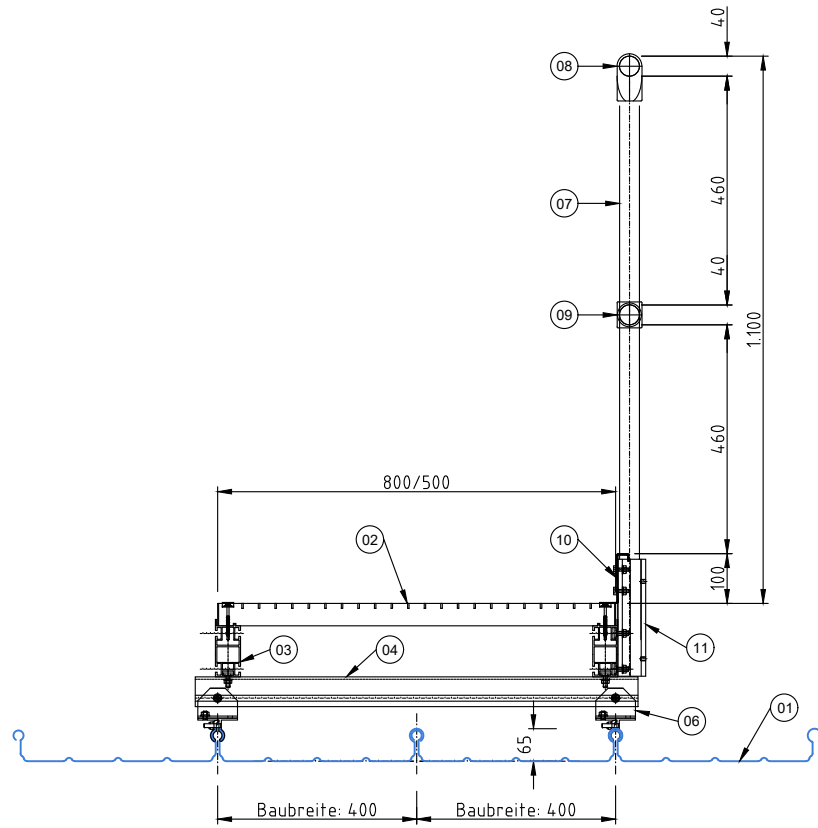
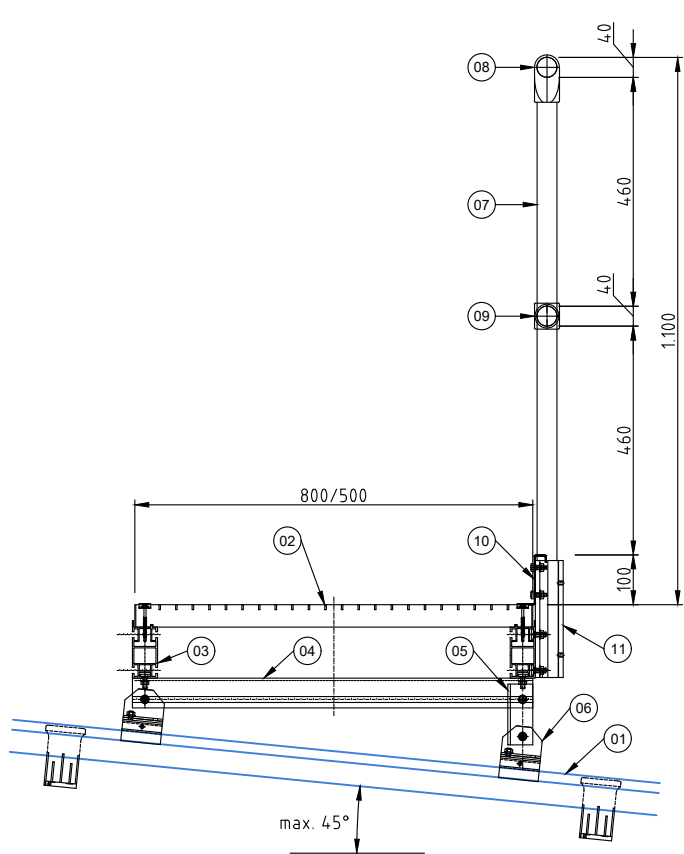

01	Kalzip Stehfalz-Profiltafel
02	Gitterrost Breite 500mm oder 800mm, Rutschhemmung R11
03	Tragprofil
04	Auflagerprofil
05	Höhenverstellung
06	Kalzip Befestigungsklemme Typ FA
07	Pfosten Ø 40mm
08	Handlauf Ø 40mm
09	Knieleiste Ø 40mm
10	Fußleiste Höhe 100mm
11	Pfostenhalter

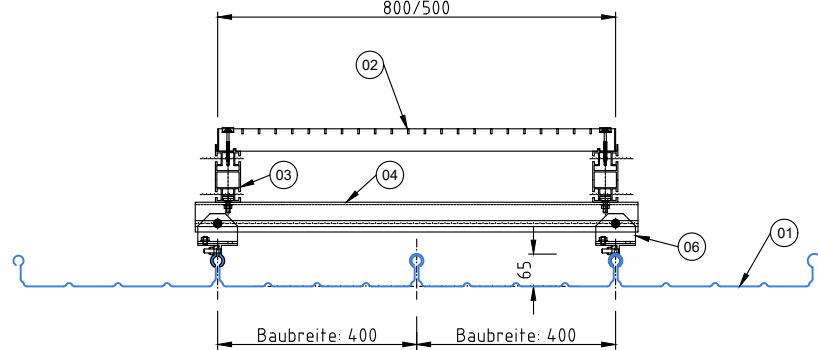
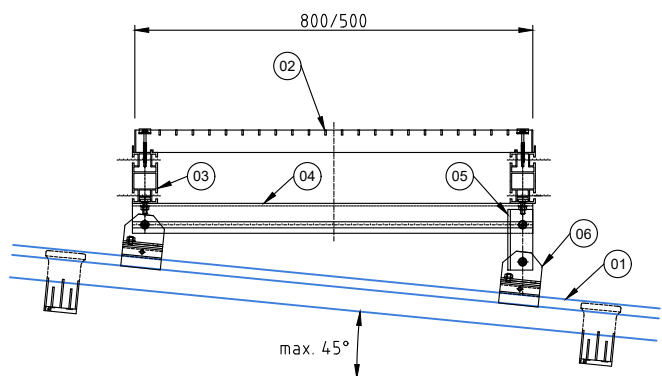

01	Kalzip standing seam profile
02	Walkway grillage, width 500mm or 800mm, non-slip
03	Hollow section, carrier profile
04	Support profile
05	Height adjustment cleat
06	Kalzip seam clamp type FA
07	Stanchion Ø 40mm
08	Top rail Ø 40mm
09	Mid rail Ø 40mm
10	Toe board, height 100mm
11	Stanchion support

System Standard ohne Geländer
System Standard without handrail

